

**MARZOCCHI**<sup>®</sup>

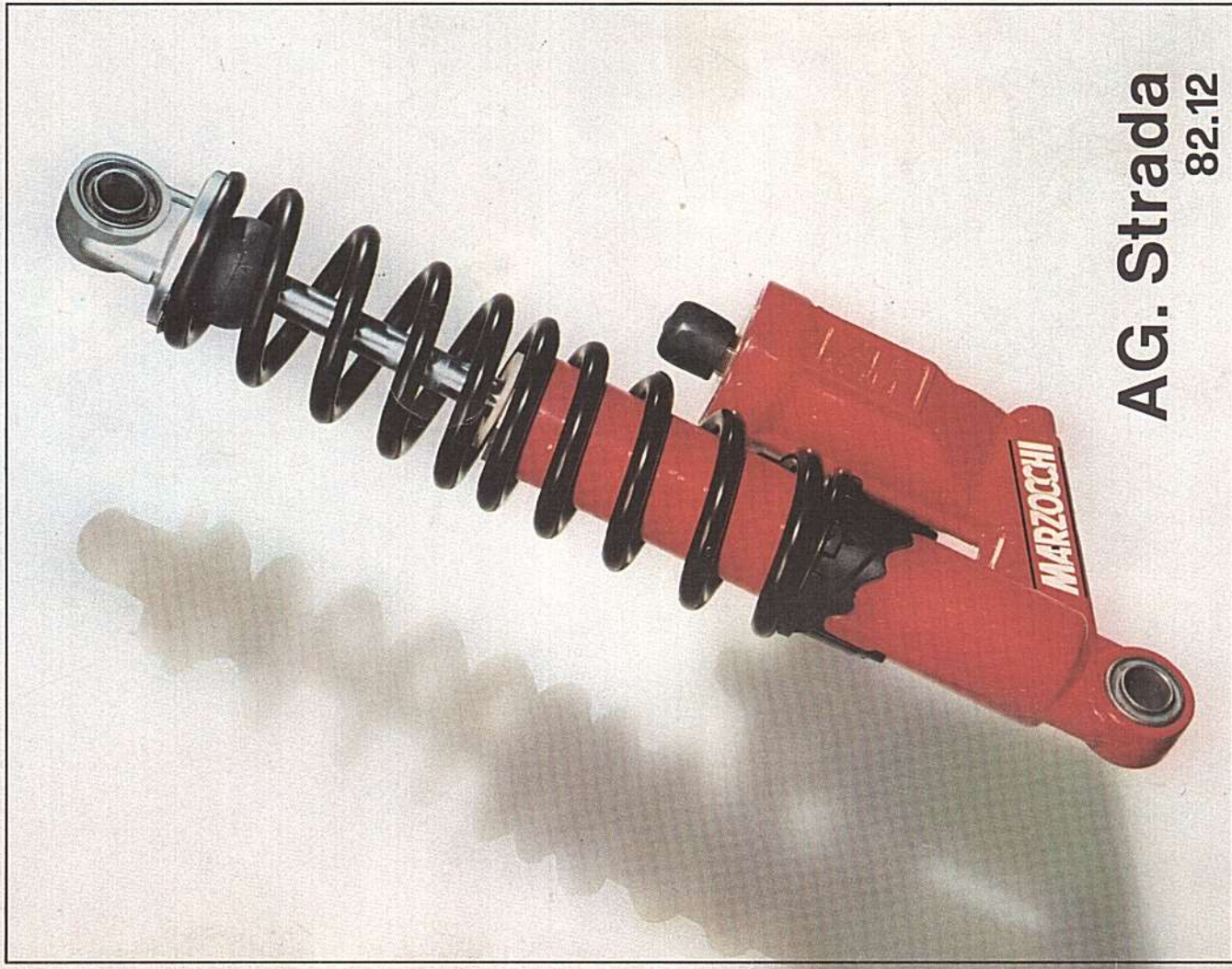

**AG. Strada**  
**82.12**

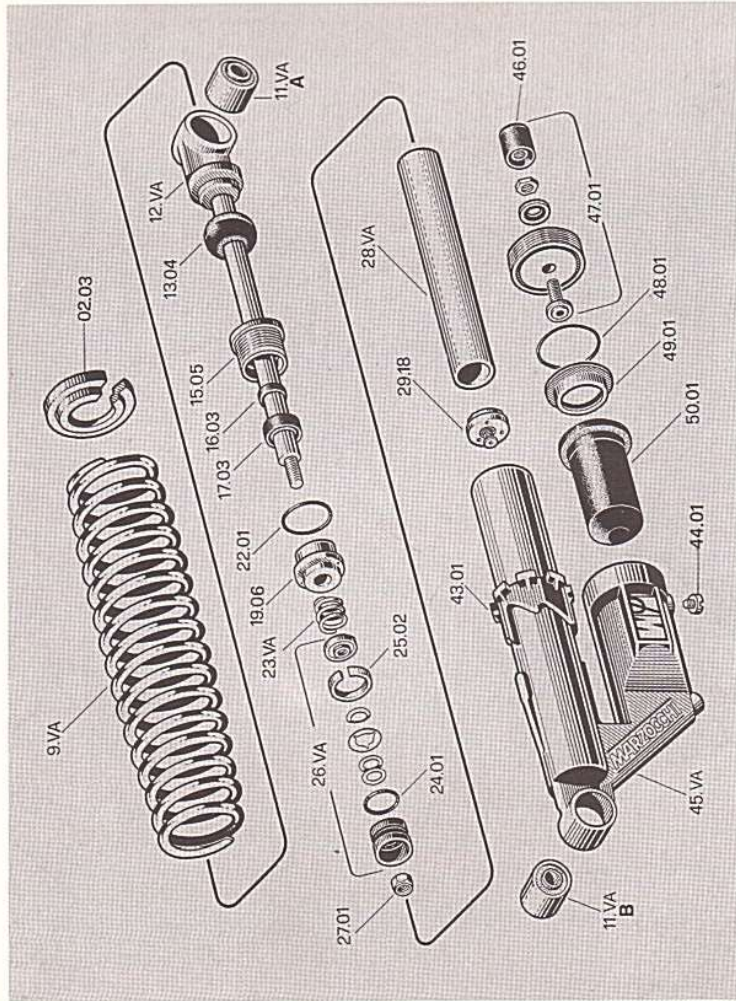



Art.	L	F	45.VA Custodia Shock body	Art.	L
11.01	22	8		45.71	196.5
11.02	22	10		45.72	221.0
11.03	22	12		45.73	176.0
11.04	22	14		45.74	199.0
11.05	24	12		45.75	191.0
11.07	20	10		45.76	198.5
11.08	20	12		45.77	206.0
11.09	20	14		45.79	228.0
11.10	Honda	16		45.81	199.0
11.13	Honda	CX		45.82	199.0
11.14	23	10	45.83	214.0	
11.21	22	10	45.84	222.0	
11.32	22	10	45.85	211.5	
			45.86	204.0	
			45.88	174.0	
			45.89	212.0	

Art.	L	28.VA Cilindro Cylinder	Art.	L	D
12.31	142.0		28.31	124.5	26
12.32	149.5		28.33	139.5	26
12.33	157.0		28.34	147.0	26
12.34	164.5		28.35	154.5	26
12.35	172.0		28.36	162.0	26
12.36	179.5		28.37	169.5	26
12.37	187.0		28.40	172.5	26
12.39	149.5		28.41	114.5	26
12.40	197.5		28.42	117.5	26
12.41	164.5		28.43	171.5	26
12.43	Honda				

Art.	L	23.VA Contromolla Rebound spring	Art.	F	D
23.14	7		26.25	1	24
23.15	10		26.26	2	24
23.16	15		26.27	3	24
23.17	20		26.28	4	24
			26.29	5	24
			26.30	6	24

Ricambi - Spare parts	27.01	Dado Nut
02.03 Anello portamollla Spring retainer	27.01	Dado Nut
13.04 Paracolpi Buffer	29.18	Valvola di fondo Foot valve
15.05 Tappo custodia Shock body plug	43.01	Registro molla Spring adjuster
16.03 Raschiapolvere Dust seal	44.01	Vite con OR Screw and O-ring
17.03 Anello di tenuta Oil seal	46.01	Cappuccio valvola Valve cap
19.06 Boccola di guida Pilot boss	47.01	Tappo con valvola Cap with valve
22.01 Anello OR O-ring	48.01	Anello OR O-ring
24.01 OR Sottosegmento Piston O-ring	49.01	Scodellino polimero Bladder cup
25.02 Segmento Piston ring	50.01	Polmone Bladder





## AG. Strada

Ricambi variabili  
Variable spare parts

Art. Item	Descrizione - Description	Inter. C. to C.	Art. Item	Ø Filo Ø Wire
87.195	BMW R60-R75-R90	340	92.57	7.20
87.196	BMW R45-R65	325	92.56	7.20
87.197	BMW R100	338	92.06	7.75
87.101	CAGIVA SST 125-250-350	312	91.04	7.00
87.104	CAGIVA XST 125	360	91.28	7.00
87.105	CAGIVA XS 250 - XS 350	340	92.02	6.75
87.230	DUCATI 350-500 GTV	320	91.34	6.75
87.231	DUCATI 750S - 750SS	310	91.29	6.75
87.232	DUCATI 900SS REPLICA	330	92.56	7.20
87.233	DUCATI 860GT - 860GTS	320	92.51	7.00
87.234	DUCATI 500 GTS	315	91.04	7.00
87.235	DUCATI 900 DARMAH SD	330	92.36	7.50
87.236	DUCATI 500 - 600 SL PANTAH	310	91.27	7.00
87.315	HONDA CB 350-400-500 - CM 400	320	91.30	7.20
87.316	HONDA CB 750 - CB 750 CUSTOM	335	92.56	7.20
87.317	HONDA GL 1000	335	92.53	8.00
87.318	HONDA XL 125S	405	91.41	7.00
87.319	HONDA CX 500 - CX 500 CM (CUSTOM)	333	92.04	7.20
87.320	HONDA CB 750 KZ - CB 750 K	355	92.55	7.50
87.321	HONDA CB 900 - CBX 1000 - 900 B.D. - CB 750 F	360	91.42	7.75
87.322	HONDA CB 250 N - CB 400 N	330	91.43	7.00
87.323	HONDA XL 250 S - XL 500 S	405	91.44	7.75
87.324	HONDA CB 650 - 650 CUSTOM	340	92.05	7.50
87.328	HONDA CB 1100 R	370	91.40	7.50
87.330	HONDA CB 125 X (ITALIA) S3 - CG 125 TWIN	315	91.03	6.75
87.331	HONDA XL 125 (ITALIA)	390	91.39	7.00

Art. Item	Ø Filo Ø Wire	A	B	12.VA	23.VA	26.VA	28.VA	45.VA
Molle a carico maggiore Heavy spring								
92.55	7.50	11.02	11.02	12.34	23.16	26.27	28.34	45.76
92.55	7.50	11.14	11.14	12.33	23.16	26.29	28.33	45.75
-	-	11.14	11.14	12.34	23.17	26.29	28.34	45.71
92.40	6.75	11.07	11.07	12.31	23.16	26.27	28.33	45.75
-	-	11.01	11.01	12.35	23.15	26.27	28.35	45.77
-	-	11.07	11.07	12.34	23.16	26.27	28.34	45.71
91.35	7.00	11.02	11.02	12.31	23.15	26.27	28.34	45.76
91.26	7.00	11.02	11.02	12.31	23.17	26.28	28.34	45.71
92.55	7.50	11.02	11.02	12.33	23.15	26.28	28.33	45.75
92.56	7.20	11.02	11.02	12.31	23.15	26.28	28.34	45.76
91.27	7.00	11.02	11.02	12.31	23.16	26.27	28.34	45.76
-	-	11.02	11.02	12.32	23.15	26.28	28.34	45.71
92.34	7.20	11.02	11.02	12.31	23.16	26.28	28.33	45.75
92.56	7.20	11.10	Vite	12.39	23.17	26.28	28.33	45.81
92.55	7.50	11.10	Vite	12.39	23.14	26.28	28.33	45.81
-	-	11.10	Vite	12.39	23.14	26.29	28.33	45.81
-	-	11.08	11.08	12.40	23.14	26.26	28.40	45.84
92.05	7.50	11.10	11.13	12.39	23.17	26.29	28.36	45.85
92.52	7.75	11.10	Vite	12.41	23.17	26.29	28.35	45.83
91.46	8.00	11.10	Vite	12.41	23.15	26.29	28.35	45.83
-	-	Vite	Vite	12.43	23.15	26.28	28.41	45.88
-	-	11.08	11.08	12.40	23.14	26.27	28.40	45.84
92.06	7.75	11.10	Vite	12.39	23.16	26.29	28.35	45.89
91.42	7.75	11.10	Vite	12.41	23.16	26.30	28.37	45.79
91.04	7.00	11.08	11.08	12.31	23.17	26.27	28.34	45.76
-	-	11.08	11.07	12.37	23.15	26.26	28.37	45.72



## AG. Strada

Ricambi variabili  
Variable spare parts

Art. Item	Descrizione - Description	Inter. C. to C.	Art. Item	Ø Filo Ø Wire
87.332	HONDA FT 500	320	91.35	7.00
87.350	KAWASAKI Z 650 - Z 650 SR - Z 750 LTD	330	91.30	7.20
87.351	KAWASAKI Z 750	320	91.30	7.20
87.352	KAWASAKI Z 400 - Z 440 LTD	320	91.04	7.00
87.353	KAWASAKI Z 900 - Z 1000 - MKII - Z1R	345	92.55	7.50
87.354	KAWASAKI Z 1300	370	91.40	7.50
87.355	KAWASAKI Z 1000 ST	345	92.55	7.50
87.356	KAWASAKI Z 500 - Z 400 J 4C	345	92.51	7.00
87.357	KAWASAKI Z 750E - Z 650F - Z 750L	335	92.56	7.20
87.358	KAWASAKI GPZ 550	350	91.55	7.00
87.359	KAWASAKI GPZ 1100 - Z 1000 J	350	91.21	7.50
87.400	LAVERDA 500	335	91.10	6.75
87.401	LAVERDA 750 GT - SF - SFC	345	92.55	7.50
87.402	LAVERDA 1000	360	91.46	8.00
87.403	LAVERDA 125 LZ	355	91.28	7.00
87.475	MOTO GUZZI V35 - II - IMOLA - V50 - III - MONZA	305	91.03	6.75
87.476	MOTO GUZZI 850T-T3-GT-V1000I-V7 750-T4	320	92.56	7.20
87.477	MOTO GUZZI 750S-S3-850 LE MANS - SP1000 NT	327	92.56	7.20
87.478	MOTO GUZZI 350 - 400 GTS	310	91.34	6.75
87.480	MOTO GUZZI LE MANS III	330	92.54	7.75
87.495	MOTO MORINI 350T - 350S	300	91.04	7.00
87.496	MOTO MORINI 500T - 500S	312	92.34	7.20
87.585	SUZUKI GS 400	320	91.04	7.00
87.586	SUZUKI GS 500E - GS 550E - GS 550L	320	92.51	7.00
87.587	SUZUKI T 500 - GT 380-550-750 - NGT 380-550	300	91.27	7.00
87.588	SUZUKI GS 750 - GSX 750 - GSX 750E - GSX 750L	320	92.41	7.75

Molle a carico maggiorato Heavy spring	Art. Item	Ø Filo Ø Wire	A	B	12.VA	23.VA	26.VA	28.VA	45.VA
			11.VA	11.VA					
	92.56	7.20	11.09	11.07	12.32	23.15	26.28	28.34	45.76
	92.56	7.20	11.09	11.07	12.31	23.17	26.28	28.34	45.76
	91.27	7.00	11.09	11.07	12.31	23.14	26.26	28.33	45.75
	92.52	7.75	11.04	11.02	12.34	23.15	26.28	28.34	45.76
	91.42	7.75	11.09	11.09	12.35	23.16	26.29	28.43	45.84
	92.52	7.75	11.04	11.04	12.34	23.15	26.28	28.34	45.76
	92.56	7.20	11.09	11.07	12.34	23.15	26.28	28.34	45.76
	92.55	7.50	11.09	11.07	12.32	23.14	26.28	28.34	45.76
	-	-	11.09	11.07	12.34	23.16	26.27	28.35	45.86
	91.40	7.50	11.09	11.07	12.32	23.16	26.29	28.37	45.72
	91.11	7.00	11.02	11.02	12.33	23.16	26.27	28.34	45.76
	92.52	7.75	11.03	11.03	12.34	23.15	26.28	28.34	45.76
	-	-	11.03	11.03	12.35	23.15	26.29	28.35	45.77
	91.40	7.50	11.05	11.05	12.31	23.14	26.27	28.37	45.72
	91.04	7.00	11.04	11.04	12.31	23.17	26.27	28.33	45.75
	92.55	7.50	11.04	11.04	12.31	23.14	26.28	28.33	45.75
	92.55	7.50	11.04	11.04	12.32	23.16	26.29	28.34	45.76
	91.35	7.00	11.03	11.03	12.31	23.16	26.27	28.33	45.75
	-	-	11.04	11.04	12.32	23.15	26.29	28.34	45.76
	91.27	7.00	11.02	11.02	12.31	23.16	26.29	28.31	45.73
	92.41	7.75	11.21	11.21	12.31	23.16	26.29	28.33	45.75
	91.27	7.00	11.08	11.08	12.31	23.14	26.26	28.33	45.75
	92.56	7.20	11.08	11.08	12.32	23.15	26.28	28.33	45.75
	92.34	7.20	11.03	11.03	12.31	23.15	26.27	28.31	45.73
	-	-	11.08	Vite	12.31	23.14	26.29	28.33	45.82





## AG. Strada

Ricambi variabili  
Variable spare parts

Art. Item	Descrizione - Description	Inter. C. to C.	Art. Item	Ø Filo Ø Wire
87.589	SUZUKI 500 RE5 - 500 W	315	92.34	7.20
87.590	SUZUKI GS 1000 T - GS 1000 S - GS 1000 E	325	95.15	7.50
87.591	SUZUKI GSX 1100	335	92.05	7.50
87.592	SUZUKI GS 850	330	92.54	7.50
87.593	SUZUKI GS 450 E - GS 450 ES	322	91.26	7.00
87.595	SUZUKI GS 1000 G - GS 850 G	325	92.36	7.50
87.596	SUZUKI GS 550 EM-KATANA	330	92.36	7.50
87.597	SUZUKI GSX 400 F	334	92.03	7.00
87.598	SUZUKI GSX 750 S - GSX 1100 S - KATANA	333	91.30	7.20
87.599	SUZUKI GS 650 GT	360	91.40	7.50
87.620	YAMAHA RD 250-350	320	91.03	6.75
87.621	YAMAHA RD 400 RS	320	91.34	6.75
87.622	YAMAHA XS 500	315	91.29	6.75
87.623	YAMAHA XS 650 - 650 TXA	320	91.27	7.00
87.624	YAMAHA XS 750	315	92.56	7.20
87.626	YAMAHA XS 250 - XS 360 - XS 400	315	91.04	7.00
87.627	YAMAHA XS 1100	320	95.08	8.00
87.628	YAMAHA RDX 125 - RD 125	320	91.02	6.50
87.630	YAMAHA XJ 650	317	91.35	7.00
87.632	YAMAHA XS 850	320	91.30	7.20
87.633	YAMAHA XJ 550	317	91.35	7.00
87.634	YAMAHA XT 500 - TT 500	370	93.08	7.50

Art. Item	Ø Filo Ø Wire	A	B	12.VA	23.VA	26.VA	28.VA	45.VA
Molle a carico maggiorato Heavy spring	7.75	11.08	Vite	12.31	23.17	26.28	28.33	45.82
-	-	11.08	Vite	12.31	23.15	26.28	28.33	45.82
92.06	7.75	11.08	Vite	12.33	23.16	26.29	28.33	45.82
-	-	11.03	11.03	12.32	23.15	26.28	28.34	45.76
91.25	7.20	11.08	11.08	12.33	23.17	26.28	28.33	45.75
95.15	7.50	11.08	11.08	12.33	23.17	26.29	28.33	45.75
95.15	7.50	11.08	11.08	12.32	23.15	26.29	28.34	45.71
92.04	7.20	11.08	11.08	12.33	23.16	26.27	28.34	45.71
92.56	7.20	11.08	Vite	12.32	23.15	26.28	28.33	45.74
91.42	7.75	11.08	11.08	12.33	23.15	26.28	28.43	45.84
91.04	7.00	11.04	11.04	12.31	23.14	26.26	28.33	45.75
91.35	7.00	11.09	11.09	12.31	23.14	26.27	28.33	45.76
91.26	7.00	11.09	11.09	12.31	23.17	26.27	28.34	45.76
92.34	7.20	11.09	11.07	12.31	23.16	26.28	28.34	45.71
92.55	7.50	11.09	11.09	12.31	23.17	26.28	28.34	45.76
92.40	6.75	11.07	11.09	12.31	23.15	26.26	28.33	45.75
-	-	11.09	11.09	12.32	23.16	26.29	28.33	45.75
91.03	6.75	11.09	Vite	12.31	23.15	26.26	28.33	45.82
92.51	7.00	11.09	11.09	12.31	23.14	26.27	28.33	45.75
92.56	7.20	11.09	11.09	12.32	23.16	26.28	28.33	45.75
92.51	7.00	11.09	11.09	12.31	23.14	26.27	28.33	45.75
93.09	7.75	11.02	11.02	12.34	23.15	26.28	28.40	45.84



**MOLLE  
SPRING**

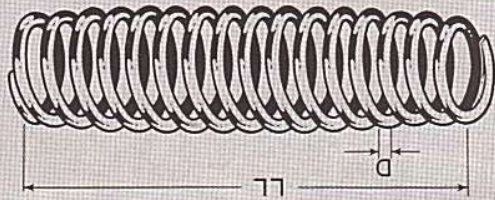

Art. Item	L.L.	Ø Filo Ø Wire	Carico in Kg		Rate Lbs. 13 3/32	3 15/16
			10 mm.	100 mm.		
92.40	190	6.75	19.0	205.0	41.8	451.0
91.27	190	7.00	23.0	227.0	50.6	499.4
92.41	190	7.75	32.0	322.0	70.4	700.4
91.02	195	6.50	14.0	152.0	30.8	334.4
91.03	195	6.75	16.0	180.0	35.2	396.0
91.04	195	7.00	18.0	220.0	39.6	184.0
91.29	205	6.75	17.0	178.0	37.4	391.6
91.26	205	7.00	20.0	198.0	44.0	435.6
91.25	205	7.20	20.0	219.0	44.0	481.8
92.36	205	7.50	24.0	265.0	52.8	583.0
91.34	210	6.75	17.5	176.5	38.5	388.5
91.35	210	7.00	17.0	177.0	37.4	389.4
92.51	210	7.00	19.0	194.0	41.8	426.8
91.30	210	7.20	20.0	208.0	44.0	457.6
92.56	210	7.20	25.0	253.0	55.0	556.6
92.54	210	7.75	30.0	318.0	66.0	699.6
95.08	210	8.00	35.0	339.0	77.0	745.8
92.53	210	8.00	35.0	385.0	77.0	847.0

**OLIO PER AMMORTIZZATORI**

Confezione da 1000 cc. circa

**SHOCK ABSORBER OIL**

1000 cc. bottle



Art. 52.46 - SAE5 (ISO 22)

**REGOLATORE DI PRESSIONE**

PRESSURE GAUGE



Art. 93.61 - VAR

**KIT AMMORTIZZATORI**

Per la manutenzione dei modelli...

**SHOCK-ABSORBER KIT**

For the maintenance of the models...



**MOLLE  
SPRING**

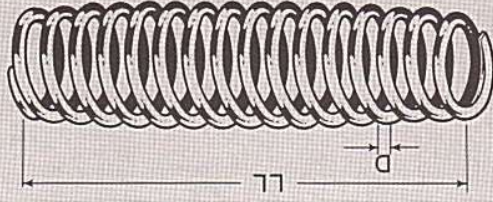

Art. Item	L.L.	Ø Filo Ø Wire	Carico in Kg		Rate Lbs. 13 3/32	3 15/16
			10 mm.	100 mm.		
92.03	220	7.00	15.0	186.0	33.0	409.2
92.04	220	7.20	19.0	209.0	41.8	459.8
92.05	220	7.50	24.0	244.0	52.8	536.8
92.06	220	7.75	27.0	264.0	59.4	580.8
91.10	225	6.75	15.0	152.0	33.0	334.4
91.11	225	7.00	15.0	163.0	33.0	358.6
92.57	225	7.20	12.0	126.0	26.4	277.2
92.55	225	7.50	27.0	280.0	59.4	616.0
91.28	240	7.00	19.0	163.0	41.8	358.6
91.21	245	7.50	21.0	215.0	46.2	473.0
91.40	245	7.50	20.0	218.0	44.0	479.6
91.42	245	7.75	23.5	248.5	51.7	546.7
91.46	245	8.00	26.6	277.0	57.2	609.4
93.09	260	7.75	19.0	213.0	41.8	468.6
91.41	290	7.00	14.0	145.0	30.8	319.0
91.44	290	7.75	20.0	200.0	44.0	400.0

**Modello  
Model**

**Art.  
Item**

MX580

54.08

GS680

54.09

AG Strada

54.01

AG3

54.02

AGT

54.03

AG2.4

54.06

AG1

54.07

A73

54.04

Euro 74

54.05

ATR 81

54.10

**MARZOCCHI**<sup>®</sup>

**SOLE DISTRIBUTOR**

Le forniture vengono effettuate alle condizioni di vendita della ditta venditrice.  
Gli ammortizzatori sono adattabili ai motocicli richiamati nel presente catalogo e possono non costituire ricambio originale degli stessi.  
I dati contenuti in questa pubblicazione sono forniti a titolo indicativo e di alcuni prodotti potrà venir meno la disponibilità.  
Le caratteristiche, anche tecniche, sono soggette a variazioni senza preavviso.  
Per informazioni aggiornate preghiamo i Sign.ri Clienti di rivolgersi all'ufficio vendite.

Deliveries will be effected under the vendors conditions of sale.

The shock absorbers are adaptable to the motorcycles listed in this catalogue, and they may not form original spare parts.  
The data contained in this publication is supplied as indicative information and some of the products may not always be available.

The characteristics, and technical parts may be changed without notice in line with our policy of continuous improvement.  
For up-to-date information all customers are requested to apply to the sales department.